

Delaware St

E Washington St

Alabama St

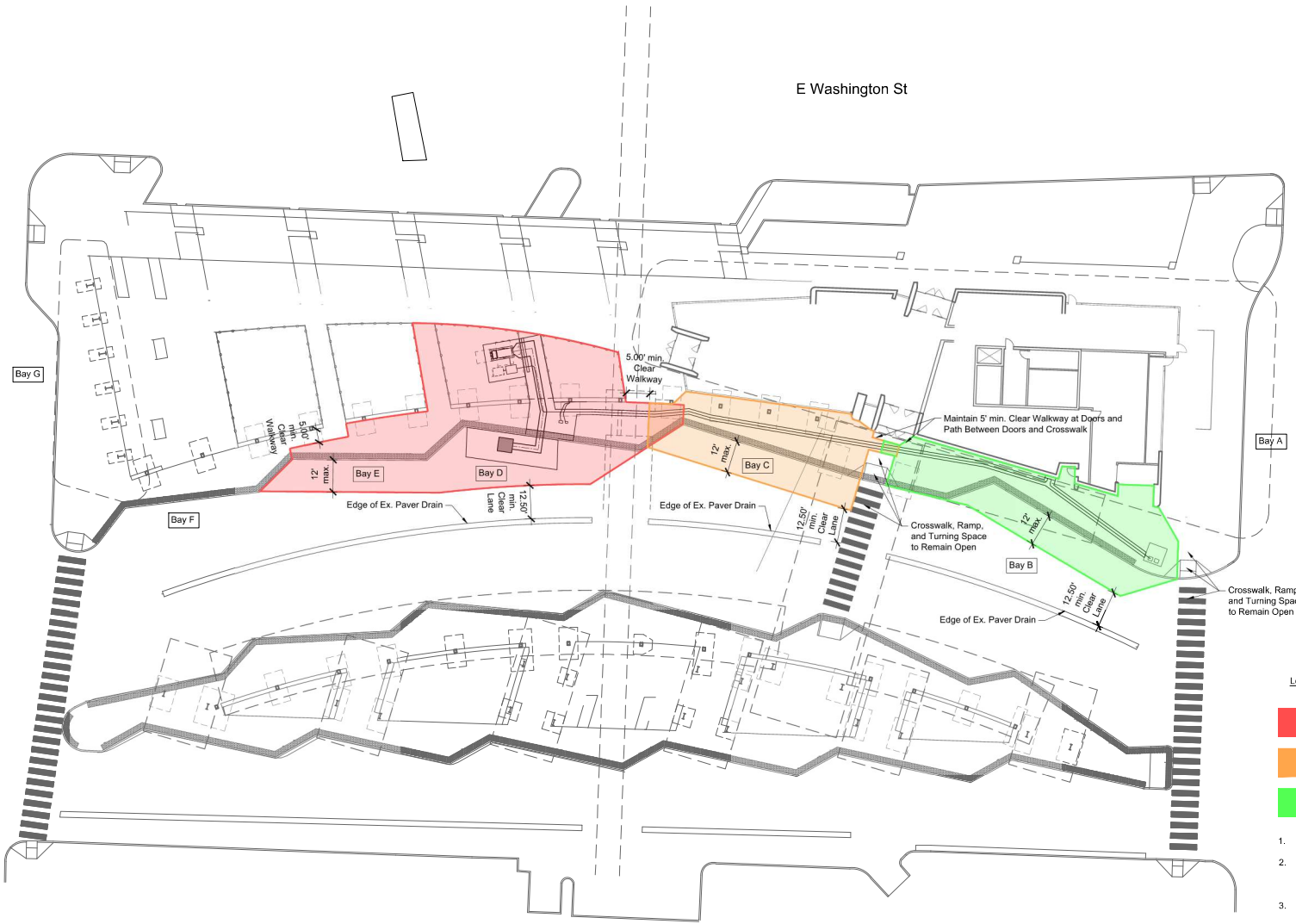

Legend & Sequence Notes

- Sequence A Work Limits - 55 calendar days  
Refer to Specifications for Details on Charging Unit Installation and Charging Unit Testing Phasing.
- Sequence B Work Limits - 10 calendar days
- Sequence C Work Limits - 10 calendar days

1. Contractor to limit work to one sequence at a time. The sequences can be worked in any order.
2. Keeping bus bays operational and maintaining access to & from them for buses and passengers is critical for IndyGo operations. The Contractor will not impact bays or walkways outside of the sequence work limits shown.
3. Contractor to coordinate bay closures with IndyGo and must receive approval from IndyGo prior to starting work or a impacting bus bay.
4. Contractor to secure work area with chain link fencing or approved equal.
5. Refer to specifications for additional details and requirements on construction sequence.

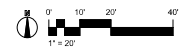

PROJECT NO.	30900792707
DRAWN BY	TJT
DATE	4/26/2024
SCALE	22'x34" 1" = 20' 11'x17" 1" = 40'

PROJECT TITLE  
**Carson Transit Center  
 (CTC) Inductive  
 Charging Project**



WSP USA, Inc.  
 110 Washington St  
 Suite 1200  
 Indianapolis, IN 46204  
 Tel: (317) 972-1700  
 Fax: (317) 972-1700



DRAWING TITLE  
**Sequence Plan**

DRAWING NUMBER  
**C201**